



**Queens Road, Loughton, Essex**

**Guide Price: £450,000 - £500,000**

# Queens Road, Loughton, Essex

GUIDE PRICE: £450,000 - £500,000

Recently refurbished and now providing a fresh and modern atmosphere is this ground floor maisonette featuring its own garden and fabulous elevated view across Loughton, with Canary Wharf in the background. The accommodation offers two bedrooms, a sitting/dining room, and a new kitchen and upgraded bathroom. The property also benefits from off street parking and a garage.

The area where you will find the property is to the northside of Loughton within what is considered to be a peaceful location, being within 0.7 miles of the open spaces and woodland areas of Epping Forest and the Foresters Arms pub. Loughton's bustling High Road is within 0.5 miles and offers a great selection of restaurants and shops, incorporating a Sainsburys, Morrisons and M & S food hall.

Loughton is also renowned for good schooling, both private and state, and for its commutability into London, especially as the Central Line station is within 1.1 miles walk. Another advantage of living in Loughton is having the activities such as horse riding and mountain biking, or simply enjoying a woodland walk within Epping Forest, and for the more energetic members of the family Loughton Leisure Centre is only 0.7 miles away.

## Accommodation & Amenities

- Ground Floor Maisonette
- Two Bedrooms
- Sitting/Dining Room
- New Kitchen and Bathroom
- Own Rear Garden
- Garage
- Off Street Parking
- Fabulous Views over Loughton with Canary Wharf beyond

LAWLORS  
— SALES LETTINGS ELITE —

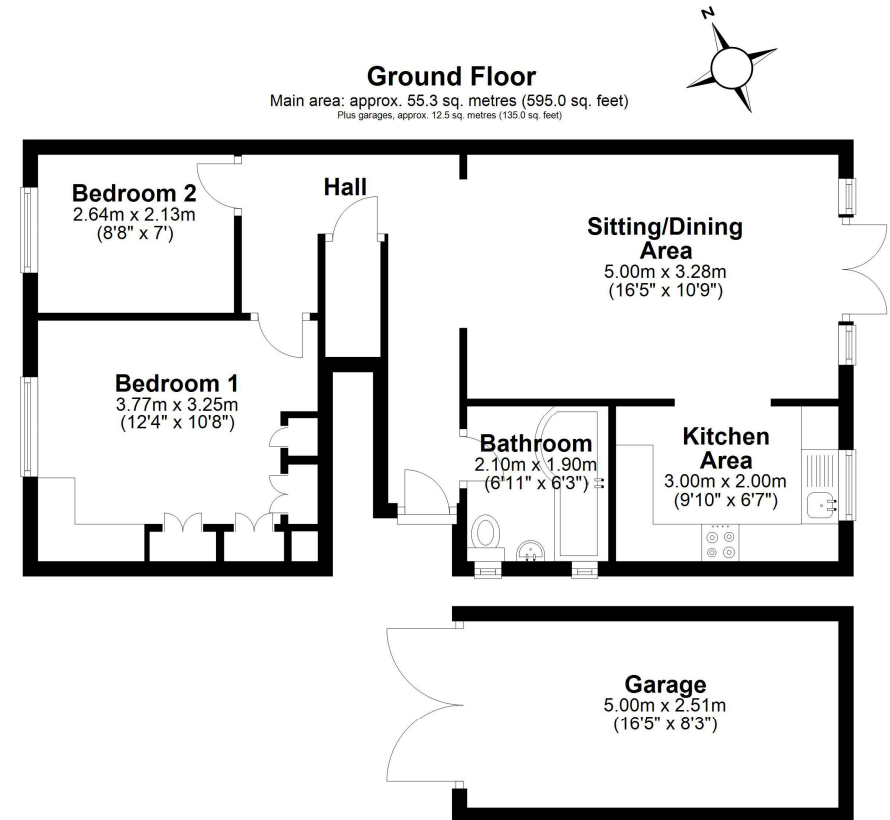

Garden is approx 14m x 6m

Main area: Approx. 55.3 sq. metres (595.0 sq. feet)  
Plus garages, approx. 12.5 sq. metres (135.0 sq. feet)



