



**Gatekeepers House, Queen Mary Avenue, London**

**Guide Price: £420,000 - £440,000**  
**Leasehold**

# Gatekeepers House, Queen Mary Avenue, London

LAWLORS  
— SALES LETTINGS ELITE —

Situated within the popular Queen Mary Avenue gated development with an inner London design, is this ground floor apartment enjoying its own enclosed terrace and a secure underground parking space. The accommodation features two double bedrooms, a family bathroom and en-suite shower room to bedroom one. Catering for modern day living is a spacious open plan living space incorporating a sitting, dining, and kitchen areas with integrated appliances. The development benefits from a 24-hour concierge services, communal gardens with water features.

Queen Mary Avenue is conveniently placed within a walking distance of a Waitrose 0.2 miles, George Lane with a selection of shops and restaurants 0.3 miles and South Woodford Central Line station is within 0.6 miles, making London very accessible. A David Lloyd Leisure Centre is only 4.2 miles away, plus the open spaces of Wanstead Park is within 2.7 miles.

## Accommodation & Amenities

- EPC: C
- Two Double Bedrooms
- Family Bathroom
- En-Suite Shower Room to Bedroom One
- Open Plan Living Space with Sitting/Dining/Kitchen Areas
- Own Enclosed Terrace
- Secure Underground Parking Space
- Communal Gardens with Water Features
- Gated Development
- 24-Hour Concierge Service

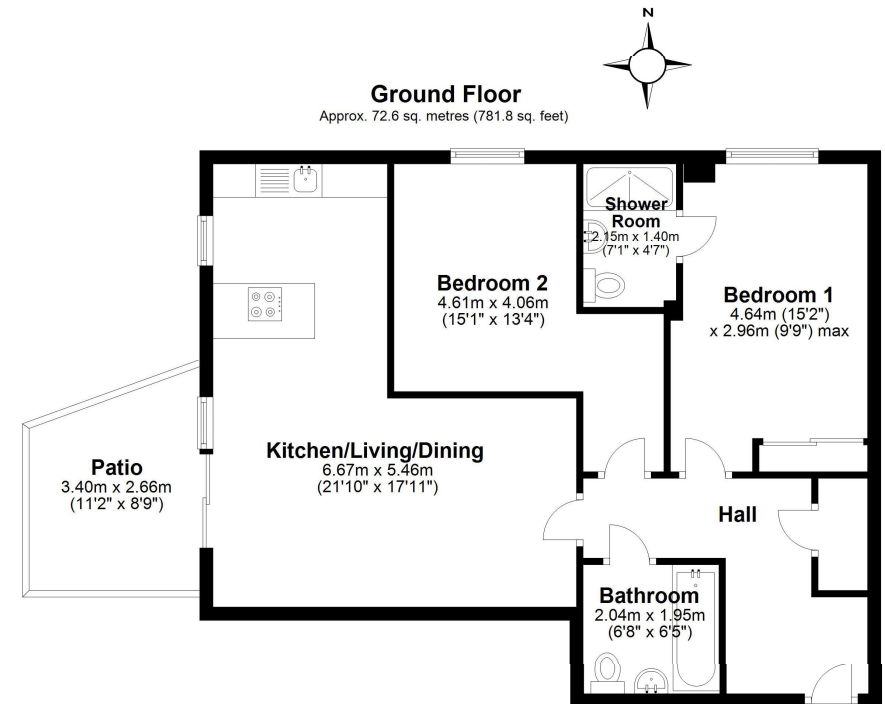

Total area: approx. 72.6 sq. metres (781.8 sq. feet)





*We may refer you to recommended providers of ancillary services such as Conveyancing, Financial Services, Insurance and Surveying. We may receive a commission payment fee or other benefit (known as a referral fee) for recommending their services. You are not under any obligation to use the services of the recommended provider. The ancillary service provider may be an associated company of Lawlors.*